

PRODUCT SHEET

Description:

Combi. Cam Lock M901, Public, 4-Digit, RH, 90DG, MK+Code Finder, Black, 73X20X15,5mm, Straight Cam C/E:40mm,, Closed 9´Clock, Open 12 O´Clock, Pre-coded 0000, Master, Key System #J13, Cylinder Centre to Edge of Lock Body: 12mm,, F/0,8-1,0mm Metal Panels Thickness, Horizontal Installation

Item number:

14.08.240-0

Units	Box	Carton	HS Code	Barcode
Pcs.	20	200	8301300000	 5704866045513

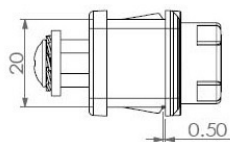
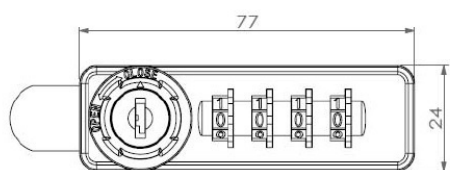

Installation diagram

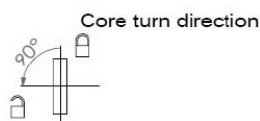
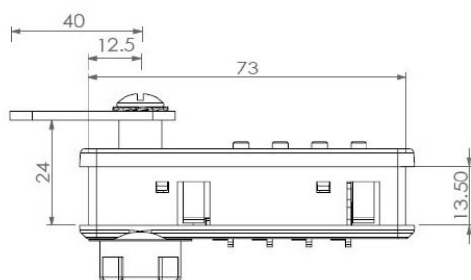
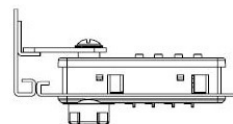

Core turn direction

0.8~1.0mm.
Installation method 1: Clamp the steel door with the lock body, the thickness of the door it is 0.8-1.0mm.

14~19 mm.
Installation method 2: Use the back panel to lock the wooden door, the thickness of the door it is 14~19mm.

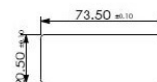
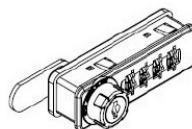

Refers to the hole size

SISO A/S

Mileparken 11
DK-2740 Skovlunde
Denmark
VAT: DK 24786013

Phone +45 45 830 900

www.siso.dk
siso@siso.dk

Danske Bank
Nytorv Branch
Copenhagen
SWIFT: DABADKKK

Account no.
4180 3112 112936
IBAN Account
DK7230003112112936